

## DRIP EDGE IN STAINLESS STEEL SHOWER TRAYS SHOULD BE SEALED WITH A SILICONE FILLED CAPPING STRIP

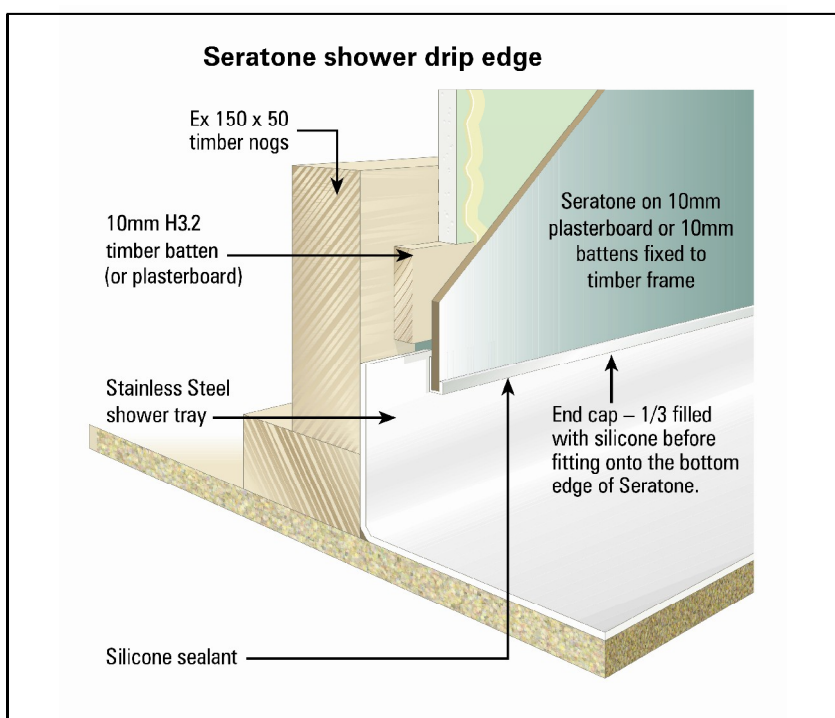

- Gap between face of stainless and back of Seratone sheet should be no less than 8mm

- Seratone to hang below the 10mm timber batten a minimum of 10mm and no more than 35mm

- An end cap (standard aluminium or PVC) is to be fixed to the bottom of the sheet. Prior to positioning the edge of the sheet into the end cap, silicone shall be applied into the jointer channel so the channel is at least 1/3 full. When the sheet is located into the channel it is likely that silicone will be forced out of the channel up the front and back of the sheet. This action should eliminate water tracking down into the channel at a later date

